

TURBOJET **HYDROX5™**

CORDLESS PRESSURE WASHER



Instruction Manual

WHAT'S INCLUDED

Turbo Jet X5

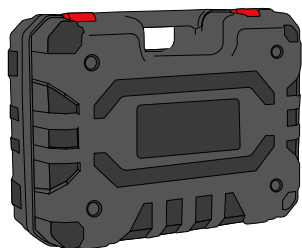

Hard Case

Flat Spray Jet Spray

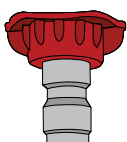

3/8"
Supply
Hose
Connect



3/4"
Hose
Quick
Connector
(Garden Hose)

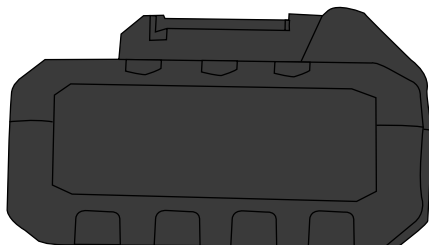

Battery Pack

WHAT'S INCLUDED



6-in-1 Nozzle

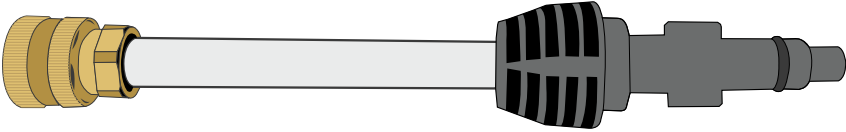

Metal Extender

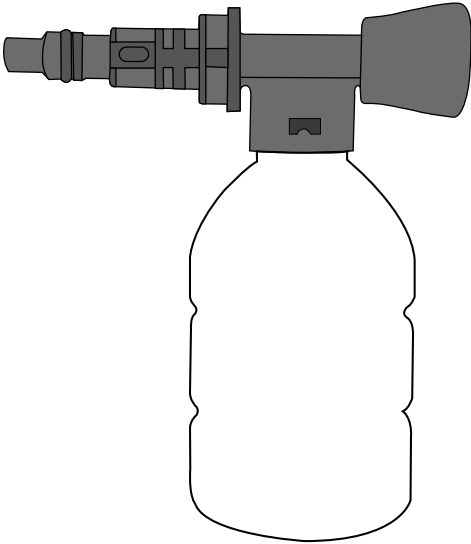

Soap Bottle

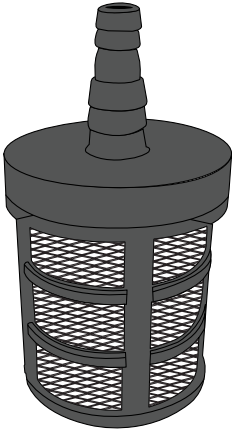

Water Filter



5m
3/8"
Hose



Power Adapter 3

CONGRATULATIONS

Get ready to unleash the power of clean!

Got questions, or hit a bump in the cleaning road? Don't stress! Head over to www.HyrdoX5FAQ.com or scan the QR code for some troubleshooting tips. Still need help? Our team's got your back, just email to: HydroX5@rephelpdesk.com

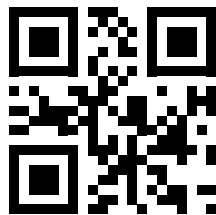

Now, go forth and wash like a pro!

ASSEMBLY:

MULTI-USE NOZZLE

1. Slide fully charged battery onto the bottom of the handle of your HyrdoJet X5 until you hear it click in place.
2. To use with Multi-Use Nozzle, insert small end of nozzle into HydroJet X5, and turn clockwise until locked in place. See Fig.1 + 2
3. Choose desired setting by turning the end of the nozzle until your chosen setting lines up with the arrow on the nozzle. See Fig. 3

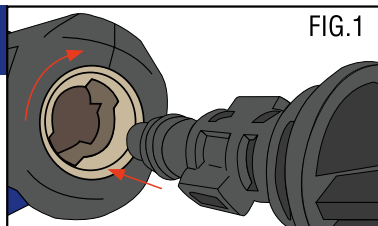

FIG.1

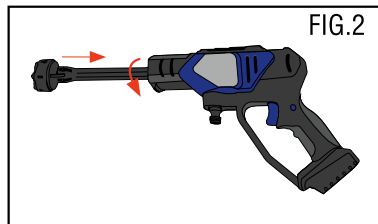

FIG.2

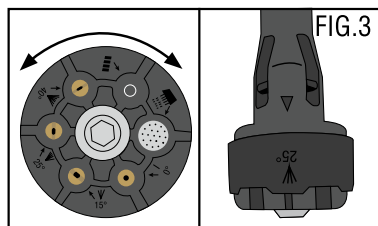

FIG.3

METAL EXTENSION ROD – FOR USE WITH JET SPRAY NOZZLE AND FLAT SPRAY NOZZLE

1. Slide fully charged battery onto the bottom of the handle of your HyrdoJet X5 until you hear it click in place.
2. To use with Metal Rod Extension, insert plastic end of rod into HydroJet X5, and turn clockwise until locked in place. See Fig. 1
3. Pull pack brass collar on end of the extension rod, and insert the Jet Spray nozzle or Flat Spray nozzle, then allow collar to spring back into place to lock. See Fig. 5

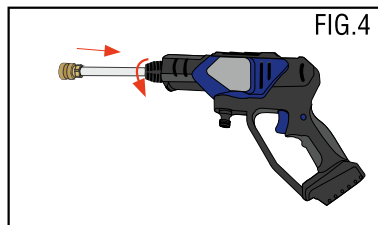

FIG.4

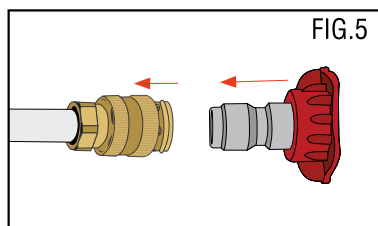

FIG.5

HOW TO USE:

CAR WASH SOAP BOTTLE

1. Slide fully charged battery onto the bottom of the handle of your HydroJet X5 until you hear it click in place.
2. To use with Car Wash Soap Bottle, insert small end of the bottle into HydroJet X5, and turn clockwise until locked in place. See Fig. 1
3. Fill bottle with amount of soap per manufacturer's recommendation.

USING WITH GARDEN HOSE

1. To use with a standard USA Garden Hose, assemble HydroJet X5 based on ASSEMBLY instructions.
2. Then, find the USA Garden Hose Quick connect adapter, slide the collar down, and attach to the bottom connection point on the HydroJet X5, allowing collar to spring back and lock into place. See Fig. 7
3. Screw your garden hose into the Quick Connect adapter, and turn water on.
4. When ready, choose HIGH OR LOW setting by using the Power Button and point HydroJet X5 at intended surface. Pull the trigger and spray until done. See Fig.8

USING WITH A BUCKET

1. To use with a water bucket, assemble HydroJet X5 based on ASSEMBLY instructions.
2. Then, find the 3/8" supply hose connect, slide the collar down, and attach to the bottom connection point on the HydroJet X5, allowing collar to spring back and lock into place. See Fig. 9
3. Unscrew the Hose Assembly piece (cone shaped piece) and set aside. Attach one end of the supply hose over the end, and slide the Hose Assembly piece through the hose, and screw back into place. See Fig.10
4. Attach the other end of the hose to the water filter, and place water filter into a water bucket. See Fig.11
5. When ready, choose HIGH OR LOW setting by using the Power Button and point HydroJet X5 at intended surface. Pull the trigger and spray until done. See Fig.8

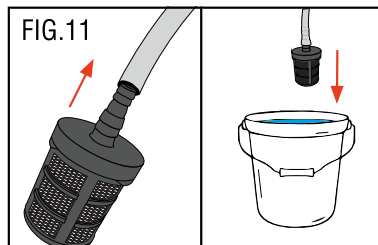
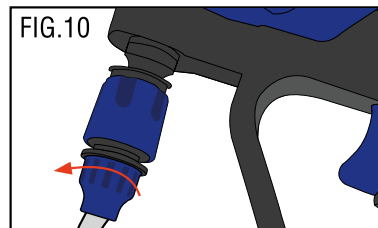
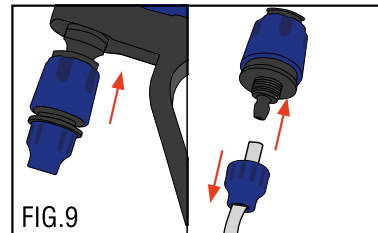
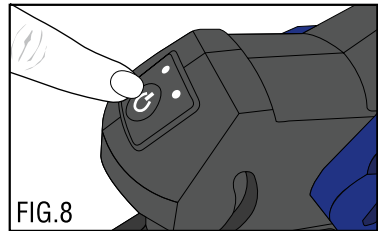
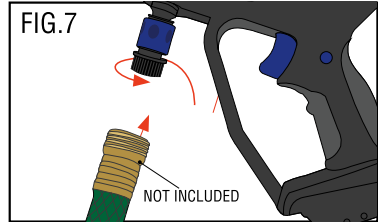
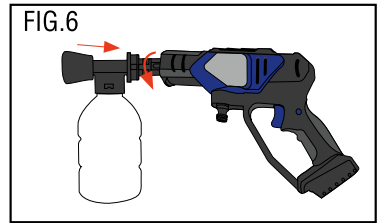

CHARGING BATTERY

1. Remove battery pack from the pressure washer
2. Plug included power adapter into an indoor standard wall outlet
3. Plug the other end into the charging port located on the battery, as seen in Fig. 12
4. When charging, indicator light will remain solid RED. When fully charged, indicator light will change to solid GREEN.

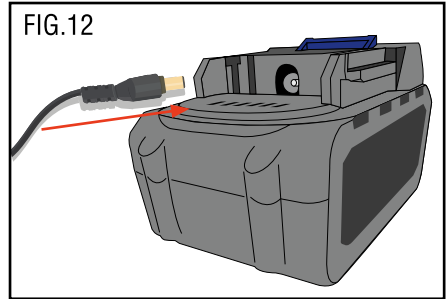

STORAGE

When done, allow all parts to air dry before putting away. When dry, place all components back in their designated spot in the hard case. Store in a cool, dry place until ready to use again.

WARNINGS

When using this product basic precautions should always be followed, including the following:

1. To reduce the risk of injury, close supervision is necessary when a product is used near children.
2. Know how to stop the product quickly. Be thoroughly familiar with the controls.
3. Stay alert – watch what you are doing.
4. Do not operate the product when fatigued or under the influence of alcohol or drugs.
5. Keep operating area clear of all persons.
6. Do not overreach or stand on unstable support. Keep good footing and balance at all times.
7. Follow the maintenance instructions specified in the manual.
8. **WARNING** – Risk of injection or injury– do not direct discharge stream at persons.
9. Do not spray electrical apparatus and wiring.
10. Prevent unintentional starting. Ensure the switch is in the off-position before connecting to battery pack, picking up or carrying the appliance. Carrying the appliance with your finger on the switch or energizing appliance that have the switch

WARNINGS

on invites accidents.

11. Disconnect the battery pack from the appliance before making any adjustments, changing accessories, or storing appliance. Such preventive safety measures reduce the risk of starting the appliance accidentally.
12. Recharge only with the charger specified by the manufacturer. A charger that is suitable for one type of battery pack may create a risk of fire when used with another battery pack.
13. Use appliances only with specifically designated battery packs. Use of any other battery packs may create a risk of injury and fire.
14. When battery pack is not in use, keep it away from other metal objects, like paper clips, coins, keys, nails, screws or other small metal objects, that can make a connection from one terminal to another. Shorting the battery terminals together may cause burns or a fire.
15. Under abusive conditions, liquid may be ejected from the battery; avoid contact. If contact accidentally occurs, flush with water. If liquid contacts eyes, additionally seek medical help. Liquid ejected from the battery may cause irritation or burns.
16. Do not use a battery pack or appliance that is damaged or modified. Damaged or modified batteries may exhibit unpredictable behavior resulting in fire, explosion or risk of injury.
17. Do not expose a battery pack or appliance to fire or excessive temperature. Exposure to fire or temperature above 130°C may cause explosion.
Follow all charging instructions and do not charge the battery pack or appliance outside of the temperature range specified in the instructions.
Charging improperly or at temperatures outside of the specified range may damage the battery and increase the risk of fire.
18. Have servicing performed by a qualified repair person using only identical replacement parts. This will ensure that the safety of the product is maintained.
19. Do not modify or attempt to repair the appliance or the battery pack (as applicable) except as indicated in the instructions for use and care.
20. Do not dismantle, open or shred battery pack.
21. Do not expose battery pack to heat or fire. Avoid storage in direct sunlight.
22. Do not short-circuit a battery pack. Do not store battery packs haphazardly in a box or drawer where they may short-circuit each other or be short-circuited by other metal objects. When battery pack is not in use, keep it away from other metal objects, like paper clips, coins, keys, nails, screws or other small metal objects, that can make a connection from one terminal to another. Shorting the battery terminals together may cause burns or fire.
23. Do not remove battery pack from its original packaging until required for use.
24. Do not subject battery pack to mechanical shock.
25. In the event of battery leaking, do not allow the liquid to come in contact with the skin or eyes. If contact has been made, wash the affected area with copious amounts of water and seek medical advice.

WARNINGS CONTINUED

26. Observe the plus (+) and minus (–) marks on the battery back and equipment and ensure correct use.
27. Do not use any battery pack which is not designed for use with the equipment.
28. Keep battery pack out of the reach of children.
29. Seek medical advice immediately if a cell or battery has been swallowed.
30. Always purchase the battery pack recommended by the device manufacturer for the equipment.
31. Keep battery pack clean and dry.
32. Wipe the battery pack terminals with a clean dry cloth if they become dirty.
33. Battery pack need to be charged before use. Always use the correct charger and refer to the manufacturer's instructions or equipment manual for proper charging instructions.
34. Do not leave battery pack on prolonged charge when not in use.
35. After extended periods of storage, it may be necessary to charge and discharge the battery pack several times to obtain maximum performance.
36. Battery pack gives its best performance when it is operated at normal room temperature ($20\text{ }^{\circ}\text{C} \pm 5\text{ }^{\circ}\text{C}$).
37. When disposing of battery packs, keep battery packs of different electrochemical systems separate from each other.
38. Recharge only with the charger included. Do not use any charger other than that specifically provided for use with the equipment. A charger that is suitable for one type of battery pack may create a risk of fire when used with another battery pack.
39. Retain the original product literature for future reference.
40. Use only the battery pack in the application for which it was intended.
41. Remove the battery pack from the equipment when not in use.
42. Dispose of properly.

Distributed by



©2024 Ontel Products Corp.
Fairfield, NJ 07004
All Rights Reserved.
Made In China

TJHXDX-IM-01-1124-200